

PRE-PRODUCTION PREVIEW

MODEL I 235

Standard Run MSRP \$74,628

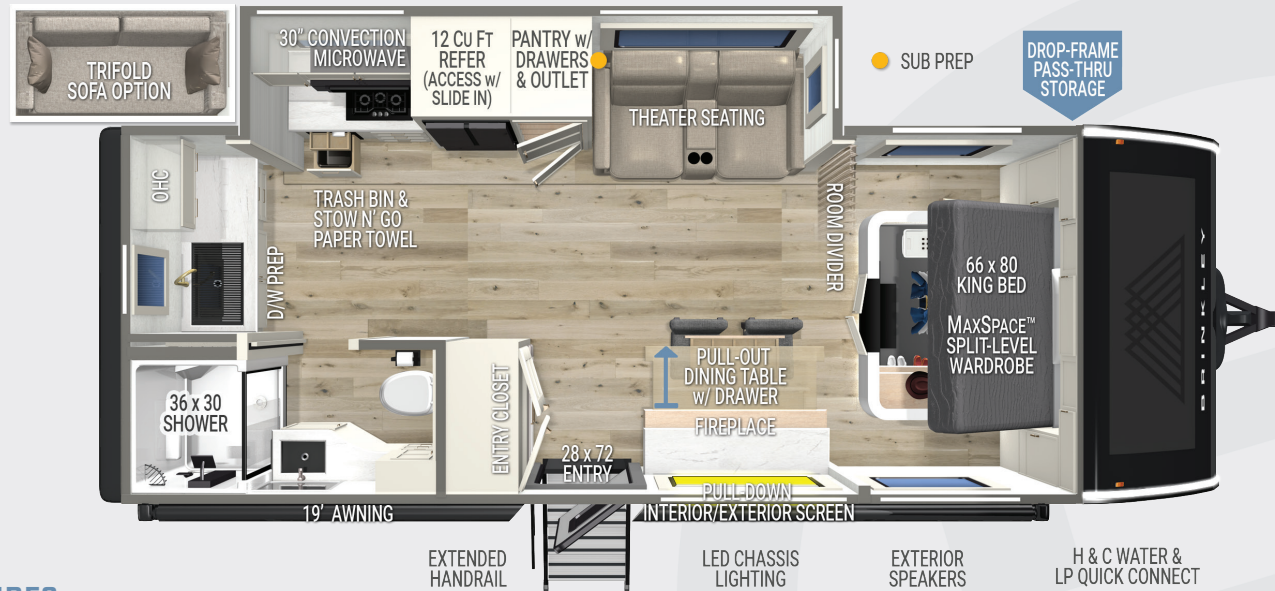

SPECIFICATIONS:

- UVW – 6,891 lbs.
- GVWR – 8,495 lbs.
- Hitch Weight – 610 lbs.
- Exterior Length – 26' 11"
- Overall Height w/ AC – 11' 4"
- Width – 96"
- Interior Height - 81"
- Slide Height - 72.5"
- Axles – Tandem 5,100 lbs.
- Wheels & Tires – 15" E-Rated (10 ply)
- Fresh Water Capacity – 55 gal
- Gray Water Capacity – 45 gal
- Black Water Capacity – 45 gal
- Insulation – Floors/Ceiling R40, Walls R9

FEATURES:

- Seamless Laminated Aluminum Exterior
- Smart Projector w/ Interior/Exterior Pull-Down Screen
- 62" Wall Hugger Theater Seating w/ 2 Recliners
- Dishwasher Prep
- Pull-Out Dining Table w/ Fireplace (Seats up to 4)
- Pull-Out Trash Bin w/ Utility Storage
- Large Pantry w/ Pull-Out Drawers & Appliance Outlet
- Premium Residential Cabinets & Drawers w/ Dovetail Joints
- Kitchen/Living Room Flush Floor Stepless Slide-Out
- 18k Chill Cube AC
- King Bed w/ Residential 7" Memory Foam Bamboo Mattress (66"x80")
- Dual Bedside Wardrobes & Nightstand Cubby w/ USB & USB-C Charging Ports (CPAP Ready)
- Brinkley MaxSpace Split-Level Wardrobe™ w/ Hanging Closet, Shelves, & Hamper
- 76" x 45" Picture Perfect Front Window w/ Insulated Blackout Privacy Shade
- One-piece 36"x30" Fiberglass Shower
- Square Euro Frameless Windows w/ 6" Openings
- Integrated Blackout Shades w/ Reflective Insulation
- Brinkley Automotive-Grade Sealant Package
- Extended Entry Latch
- Sleek Styling w/ Automotive-Grade Exterior Graphics
- 2 – Hot/Cold Outdoor Showers (BOTH Sides of Coach)
- Tankless On-Demand Water Heater
- Rockford Fosgate Sound System w/ Subwoofer Prep
- Heated & Enclosed Underbelly (Circulated Forced Air)
- 4-Point Power Stabilizer Jack System
- Drop Frame Chassis w/ LED Ground Lighting
- Brinkley On-Command™ Docking & Utility Center w/ Retractable 65' Water Hose
- Industry First Brass Plumbing Fittings
- Industry First Low-Maintenance Roof
- Hankook E 10-Ply Tires w/ 15" Custom Wheels
- Anti-Lock Brakes (ABS) w/ Anti-Sway & Dynamic Brake Boost
- 200W Solar Panel w/ 30 AMP Victron MPPT Solar Controller (600W Solar & Lithium Ready) + 3000W Inverter
- 50-amp Electric Service

FACTORY OPTIONS:

- Dual Pane Windows \$1,731
- 62" Trifold Sofa (50"x70 Sleeper) \$428

052225

PRE-PRODUCTION PREVIEW

Based on pre-production prototype. All preliminary info & content is subject to change without notice. Please consult with your dealer for current model details & information.

LAMESA REC VAN
LaMesaRV.com
800-496-8778

BRINKLEY

For More Information, Photos, Videos
& Why Brinkley go to **BrinkleyRV.com**



MODEL I 265

Standard Run MSRP \$73,125

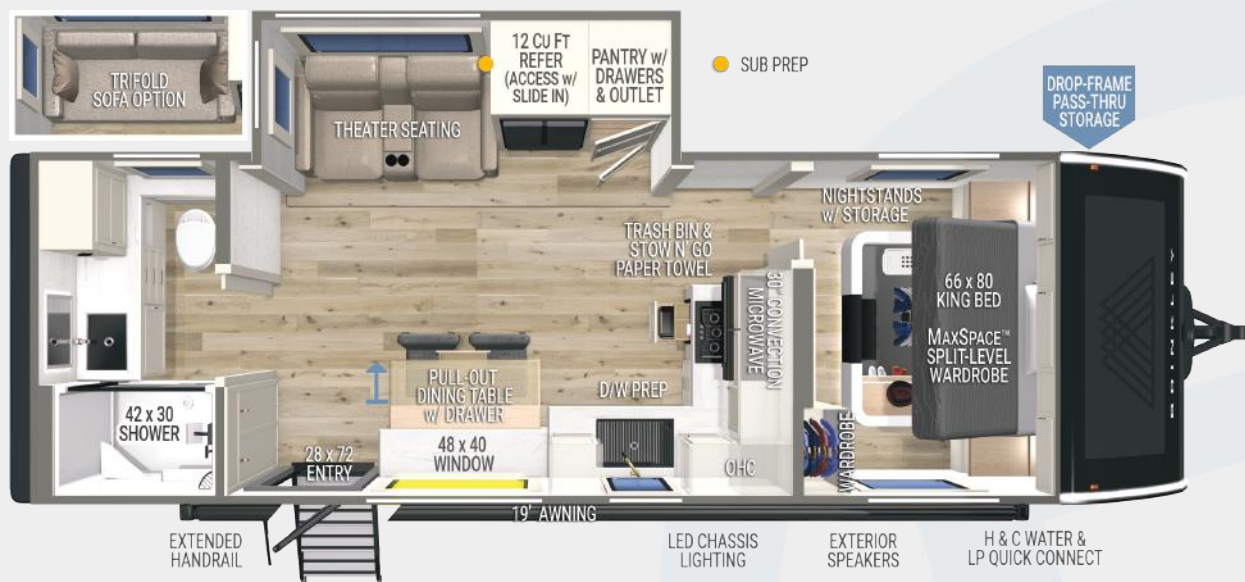

SPECIFICATIONS:

- UVW – 7,298
- GVWR – 9,600 lbs.
- Hitch Weight – 659 lbs.
- Exterior Length – 29' 11"
- Overall Height w/ AC – 11' 4"
- Width – 96"
- Interior Height - 81"
- Slide Height - 72.5"
- Axles – Tandem 5,100 lbs.
- Wheels & Tires – 15" E-Rated (10 ply)
- Fresh Water Capacity – 55 gal
- Gray Water Capacity – 80 gal
- Black Water Capacity – 40 gal
- Insulation – Floors/Ceiling R40, Walls R9

FEATURES:

- Seamless Laminated Aluminum Exterior
- Smart Projector w/ Pull-Down Projection Screen
- 62" Wall Hugger Theater Seating w/ 2 Recliners
- Dishwasher Prep
- Pull-Out Dining Table w/ Utensil Drawer (Seats up to 4)
- Pull-Out Trash Bin w/ Utility Storage
- Large Pantry w/ Pull-Out Drawers & Appliance Outlet
- Premium Residential Cabinets & Drawers w/ Dovetail Joints
- Living Room Flush Floor Stepless Slide-Out
- 18k Chill Cube Main AC & 8k Bedroom AC
- King Bed w/ Residential 7" Memory Foam Bamboo Mattress (66"x80")
- Dual Bedside Nightstands w/ Deep Storage & Outlets w/ USB & USB-C Charging Ports (CPAP Ready)
- Brinkley MaxSpace Split-Level Wardrobe™ w/ Hanging Closet, Shelves, & Hamper
- 76" x 45" Picture Perfect Front Window w/ Insulated Blackout Privacy Shade
- One-piece 42"x30" Fiberglass Shower w/ Built-In Seat
- Square Euro Frameless Windows w/ 6" Openings
- Integrated Blackout Shades w/ Reflective Insulation
- Brinkley Automotive-Grade Sealant Package
- Extended Entry Latch
- Sleek Styling w/ Automotive-Grade Exterior Graphics
- 2 – Hot/Cold Outdoor Showers (BOTH Sides of Coach)
- Tankless On-Demand Water Heater
- Rockford Fosgate Sound System w/ Subwoofer Prep
- Heated & Enclosed Underbelly (Circulated)
- 4-Point Power Stabilizer Jack System
- Drop Frame Chassis w/ LED Ground Lighting
- Brinkley On-Command™ Docking & Utility Center w/ Retractable 65' Water Hose
- Industry First Brass Plumbing Fittings
- Industry First Low-Maintenance Roof
- Hankook E 10-Ply Tires w/ 15" Custom Wheels
- Anti-Lock Brakes (ABS) w/ Anti-Sway & Dynamic Brake Boost
- 200W Solar Panel w/ 30 AMP MPPT Controller (600W Solar & Lithium Ready) + 3000W Inverter
- 50-amp Electric Service

FACTORY OPTIONS:

- Dual Pane Windows \$1,731
- 64" Trifold Sofa (52"x70 Sleeper) \$428

PRE-PRODUCTION PREVIEW

Based on pre-production prototype. All preliminary info & content is subject to change without notice. Please consult with your dealer for current model details & information.

LAMESA REC VAN

LaMesaRV.com
800-496-8778

BRINKLEY

For More Information, Photos, Videos
& Why Brinkley go to **BrinkleyRV.com**



041625

MODEL I 275

Standard Run MSRP \$76,746

SPECIFICATIONS:

- UVW – 7,485 lbs.
- GVWR – 9,600 lbs.
- Hitch Weight – 705 lbs.
- Exterior Length – 30' 11"
- Overall Height w/ AC – 11' 4"
- Width – 96"
- Interior Height - 81"
- Slide Height - 72.5"
- Axles – Tandem 5,100 lbs.
- Wheels & Tires – 15" E-Rated (10 ply)
- Fresh Water Capacity – 55 gal
- Gray Water Capacity – 75 gal
- Black Water Capacity – 40 gal
- Insulation – Floors/Ceiling R40, Walls R9

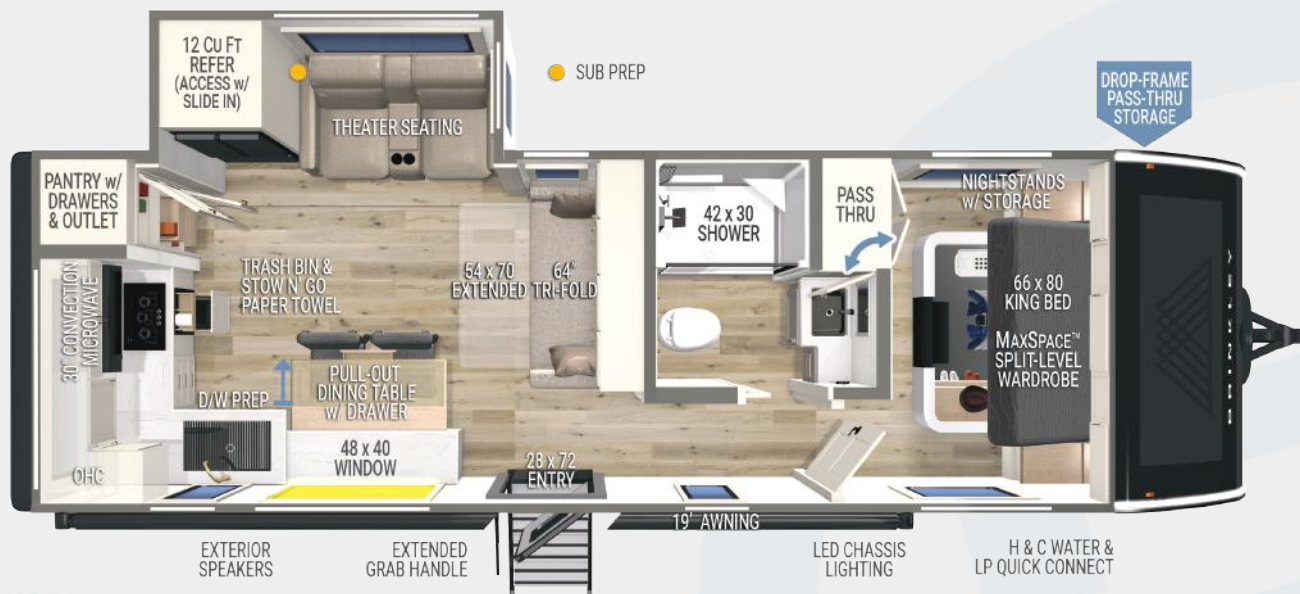

FEATURES:

- Seamless Laminated Aluminum Exterior
- Smart Projector w/ Pull-Down Projection Screen
- 62" Wall Hugger Theater Seating w/ 2 Recliners
- 64" Trifold Sofa (54"x70 Sleeper)
- Dishwasher Prep
- Pull-Out Dining Table w/ Utensil Drawer (Seats up to 4)
- Pull-Out Trash Bin w/ Utility Storage
- Large Pantry w/ Pull-Out Drawers & Appliance Outlet
- Premium Residential Cabinets & Drawers w/ Dovetail Joints
- 18k Chill Cube Main AC & 8k Bedroom AC
- King Bed w/ Residential 7" Memory Foam Bamboo Mattress (66"x80")
- Dual Bedside Nightstands w/ Deep Storage & Outlets w/ USB & USB-C Charging Ports (CPAP Ready)
- Brinkley MaxSpace Split-Level Wardrobe™ w/ Hanging Closet, Shelves, & Hamper
- 76" x 45" Picture Perfect Front Window w/ Insulated Blackout Privacy Shade
- One-piece 42"x30" Fiberglass Shower w/ Built-In Seat
- Square Euro Frameless Windows w/ 6" Openings
- Integrated Blackout Shades w/ Reflective Insulation
- Living Room Flush Floor Stepless Slide-Out
- Brinkley Automotive-Grade Sealant Package
- Extended Entry Latch
- Sleek Styling w/ Automotive-Grade Exterior Graphics
- 2 – Hot/Cold Outdoor Showers (BOTH Sides of Coach)
- Tankless On-Demand Water Heater
- Rockford Fosgate Sound System w/ Subwoofer Prep
- Heated & Enclosed Underbelly (Circulated)
- 4-Point Power Stabilizer Jack System
- Drop Frame Chassis w/ LED Ground Lighting
- Brinkley On-Command™ Docking & Utility Center w/ Retractable 65' Water Hose
- Industry First Brass Plumbing Fittings
- Industry First Low-Maintenance Roof
- Hankook E 10-Ply Tires w/ 15" Custom Wheels
- Anti-Lock Brakes (ABS) w/ Anti-Sway & Dynamic Brake Boost
- 200W Solar Panel w/ 30 AMP MPPT Controller (600W Solar & Lithium Ready) + 3000W Inverter
- 50-amp Electric Service

FACTORY OPTIONS:

- Dual Pane Windows \$1,731

PRE-PRODUCTION PREVIEW

Based on pre-production prototype. All preliminary info & content is subject to change without notice. Please consult with your dealer for current model details & information.

LaMESA RV

LaMesaRV.com
800-496-8778

BRINKLEY

For More Information, Photos, Videos
& Why Brinkley go to **BrinkleyRV.com**



041725

MODEL I 294

AVAILABLE STARTING IN APRIL
Standard Run MSRP \$83,412

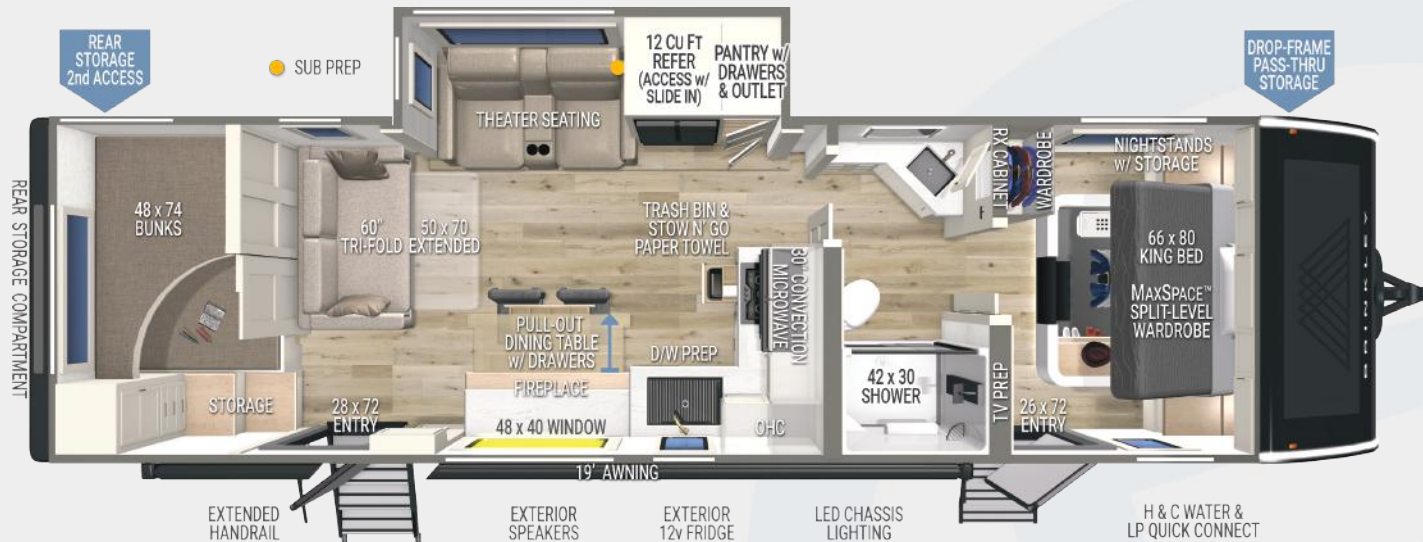

SPECIFICATIONS:

- UVW – 8,420 lbs.
- GVWR – 10,395 lbs.
- Hitch Weight – 796 lbs.
- Exterior Length – 34' 10"
- Overall Height w/ AC – 11' 4"
- Width – 96"
- Interior Height - 81"
- Slide Height - 72.5"
- Axles – Tandem 5,100 lbs.
- Wheels & Tires – 15" E-Rated (10 ply)
- Fresh Water Capacity – 55 gal
- Gray Water Capacity – 65 gal
- Black Water Capacity – 35 gal
- Insulation – Floors/Ceiling R40, Walls R9

FEATURES:

- Seamless Laminated Aluminum Exterior
- Second Bedroom w/ 48"x74" Double Mattress Bunks
- Smart Projector w/ Pull-Down Projection Screen
- 62" Wall Hugger Theater Seating w/ 2 Recliners
- 60" Trifold Sofa (50"x70 Sleeper)
- Dishwasher Prep
- Pull-Out Dining Table w/ Drawers (Seats up to 4)
- Fireplace w/ Electric Heat
- Pull-Out Trash Bin w/ Utility Storage
- Large Pantry w/ Pull-Out Drawers & Appliance Outlet
- Premium Residential Cabinets & Drawers w/ Dovetail Joints
- Living Room Flush Floor Stepless Slide-Out
- King Bed w/ Residential 7" Memory Foam Bamboo Mattress (66"x80")
- Dual Bedside Nightstands w/ Deep Storage & Outlets w/ USB & USB-C Charging Ports (CPAP Ready)
- Brinkley MaxSpace Split-Level Wardrobe™ w/ Hanging Closet, Shelves, & Hamper
- 18k Chill Cube Main AC & 8k Bedroom AC
- 76" x 45" Picture Perfect Front Window w/ Insulated Blackout Privacy Shade
- One-piece 42"x30" Fiberglass Shower w/ Built-In Seat
- Square Euro Frameless Windows w/ 6" Openings
- Integrated Blackout Shades w/ Reflective Insulation
- Brinkley Automotive-Grade Sealant Package
- Sleek Styling w/ Automotive-Grade Exterior Graphics
- 2 – Hot/Cold Outdoor Showers (BOTH Sides of Coach)
- Tankless On-Demand Water Heater
- Rockford Fosgate Sound System w/ Subwoofer Prep
- Heated & Enclosed Underbelly (Circulated)
- 4-Point Power Stabilizer Jack System
- Drop Frame Chassis w/ LED Ground Lighting
- Brinkley On-Command™ Docking & Utility Center w/ Retractable 65' Water Hose
- Industry First Brass Plumbing Fittings
- Industry First Low-Maintenance Roof
- Hankook E 10-Ply Tires w/ 15" Custom Wheels
- Anti-Lock Brakes (ABS) w/ Anti-Sway & Dynamic Brake Boost
- 200W Solar Panel w/ 30 AMP MPPT Controller (600W Solar & Lithium Ready) + 3000W Inverter
- 50-amp Electric Service

FACTORY OPTIONS:

- Dual Pane Windows \$1,731

041725

PRE-PRODUCTION PREVIEW

Based on pre-production prototype. All preliminary info & content is subject to change without notice. Please consult with your dealer for current model details & information.

LaMESA REC VAN
LaMesaRV.com
800-496-8778

BRINKLEY

For More Information, Photos, Videos
& Why Brinkley go to **BrinkleyRV.com**

